

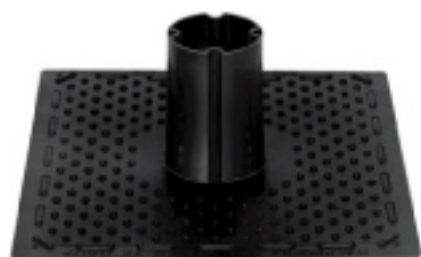

Art. 48.3

Art. 48.8

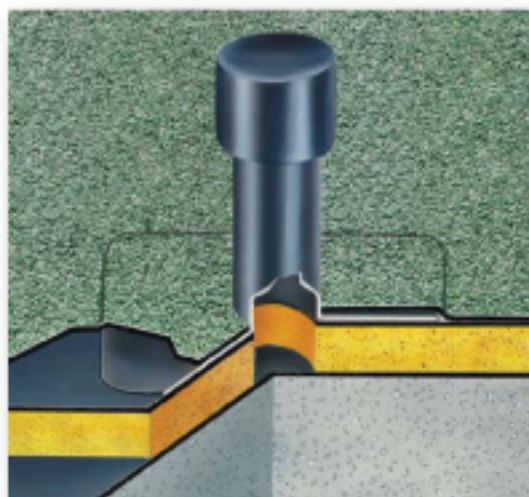

Art. 51
Tube connector

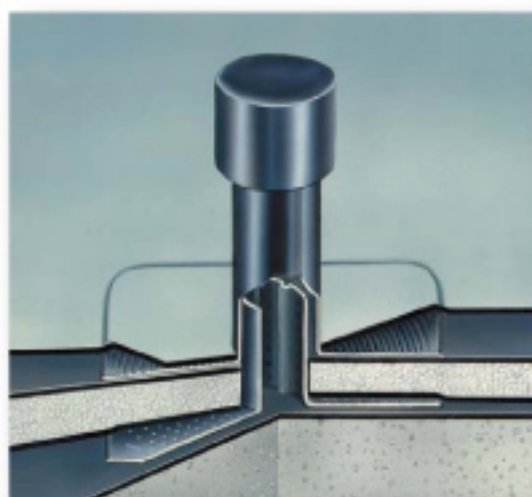

Art. 49.7

Art. 49.8



Art. 48 - 49 - 49.1 - 49.9 are suitable for application with waterproofing membranes such as APP,SBS and roofs covered with hot bitumen or tarred felt. Air Vents designed and patented by ITALPROFILI® is one of the most effective ventilation system as it discharges steam build-up under the waterproofing. It does not reduce the water repellent capacity of either the prefabricated membranes or the bitumen covering or the insulation capacity of the waterproofing. It avoids serious inconveniences such as curling, topping-up, damp insulating sheeting, with consequent partial or total loss of its properties. Due to a very careful construction and the used materials, ITALPROFILI® air vent has all specific features to prevent such drawbacks.

ART.	48	49
B	280x280	320x320
D	75	75
H	200	270
H1	80	80
D1	110	110

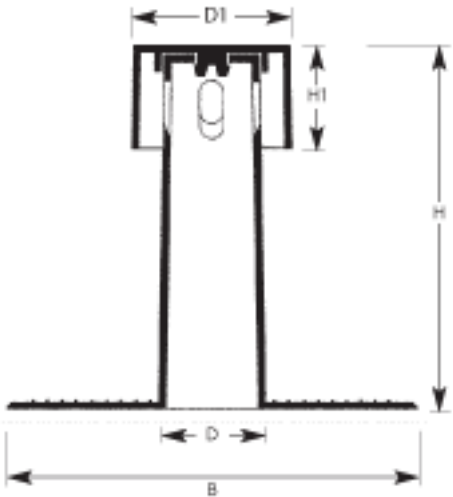

ART.	51
B	365x365
D1	67
H	100
D	60

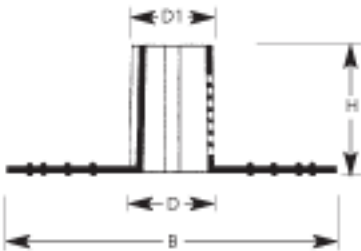

AIR VENT Art. 49.1 - 49.9 are suitable for use on various ventilation, considered the dimensions, can be applied on pipes coming from beneath Ø 100-110. Art. 49.1 and 49.9 are suitable for application with waterproofing membranes such as APP,SBS.

ART.	49.1	49.9
B	357x357	357x357
D	110	110
H	325	500
H1	95	95
D1	145	145

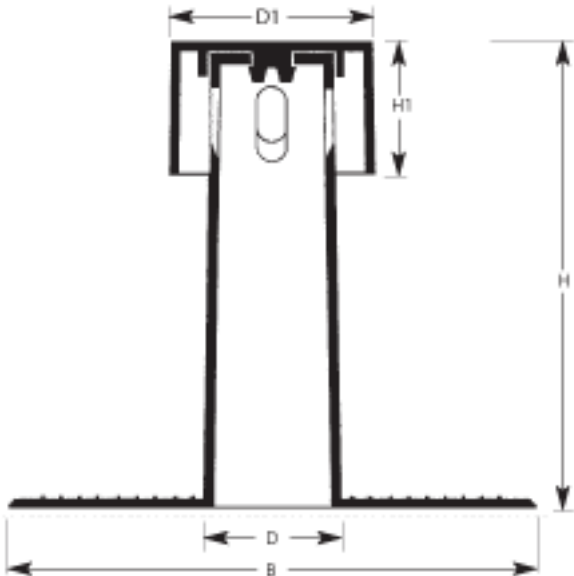

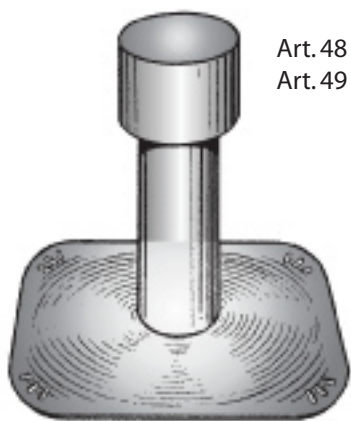

Art. 48 H mm. 200 Ø 75
Art. 49 H mm. 270 Ø 75

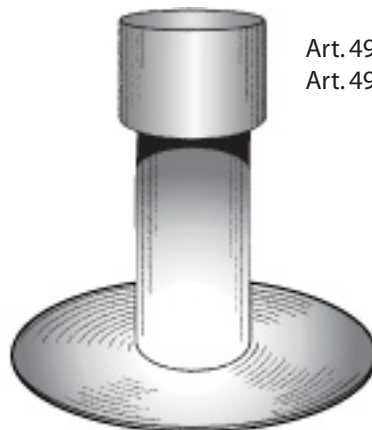

Art. 49.1 H mm. 325 Ø 110
Art. 49.9 H mm. 500 Ø 110

- A - Aerator
- B - Waterproof mantle
- C - First layer or piece of membrane
- D - Insulation
- E - Canalizer
- F - Steam barrier
- G - Floor

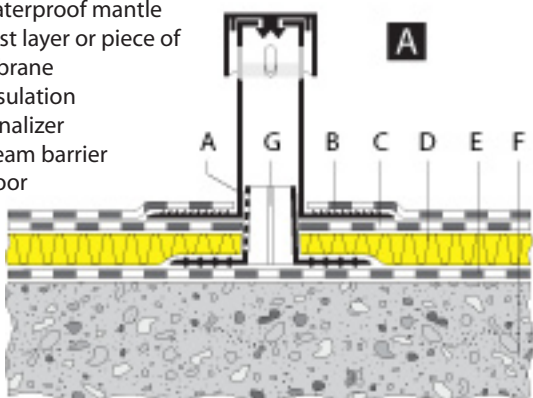

- A - Aerator
- B - Waterproof mantle
- C - First layer or piece of membrane
- D - Insulation
- E - Steam barrier
- F - Floor

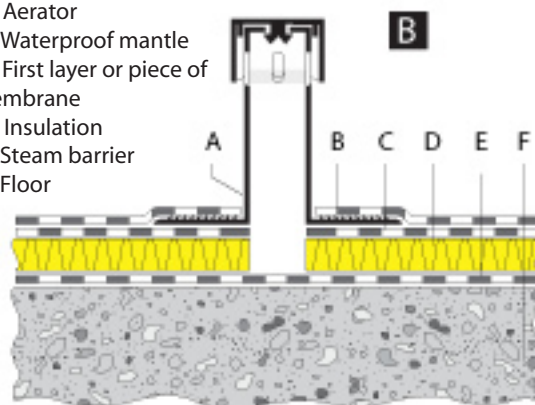

- A - Aerator
- B - Waterproof mantle
- C - First layer or piece of membrane
- D - Insulation
- E - Steam barrier
- F - Floor

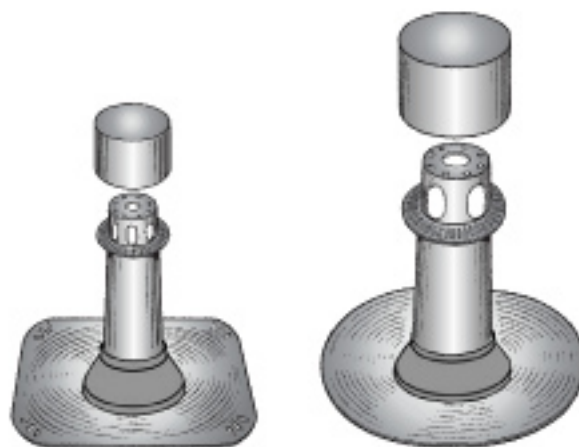
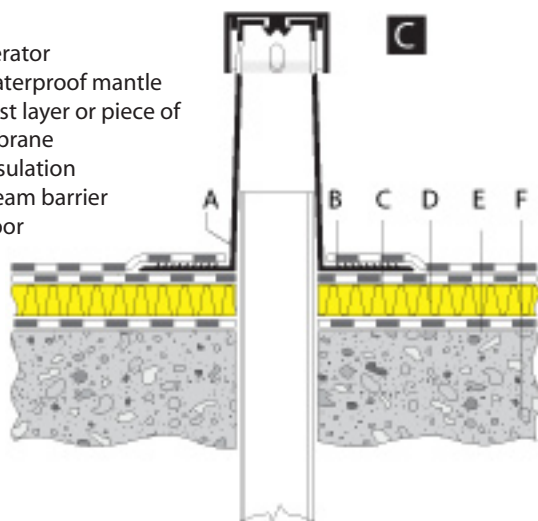

INSTALLATION METHOD

Art. 48 - 49 - 49.1 - 49.9

Supposing that the steam barrier has already been placed on the slab, drill it where the duct for air vent is placed on the highest points of the covering, by simply laying it (drawing A). Then lay the insulating panel, appropriately drilled for the passage of the central body of the duct for air vent. The first layer of waterproof membrane is to be laid drilling it by the duct for air vent, and the surface that will be covered by the aerator flange is to be heated by flame, then lay the aerator. Lay the second waterproof membrane without bending the emerging part of the aerator (in case of stiff insulation, you can omit the duct for air vent, see drawing B, and in case of a single membrane layer, use a piece of 50x50 cm., appropriately drilled as second layer).

DESCRIPTION OF SPECIFICATIONS Art. 48 - 49

Supply and laying of aerators for ventilations between, steam barrier and waterproofing, art. 48-49 provided with anti insect ring and collar. Air vents shall be of IGOM EE of the ITALPROFILI® type and laid between the last two membranes layers, supplied with a cover which is press fitted as an insect barrier. We suggest one piece each 30 m2.

DESCRIPTION OF SPECIFICATIONS Art. 49.1 - 49.9

Supply and laying of aerators for ventilations of kitchens, bathrooms, pipes coming from beneath, provided with anti insect ring and collar, art. 49.1 h. 325 Ø 110, art. 49.9 h. 500 Ø 110. ITALPROFILI® air vents type and laid between the last two membranes layers, supplied with a cap which is press fitted as an insect barrier with a ribbed flange which is welded into position between the first and second layer of the waterproofing membranes.

Italprofili air vents must be made from IGOM EE by ITALPROFILI® (drawing C).